

Verpackt in Gurtverpackung  
Tape on Reel Packaging  
Verpackungseinheit: 260 Stück  
Packaging unit: 260 pcs

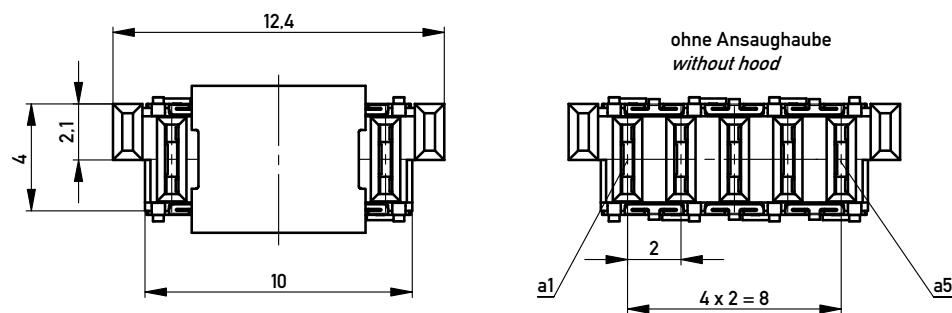

Abspulrichtung - Reel off Direction

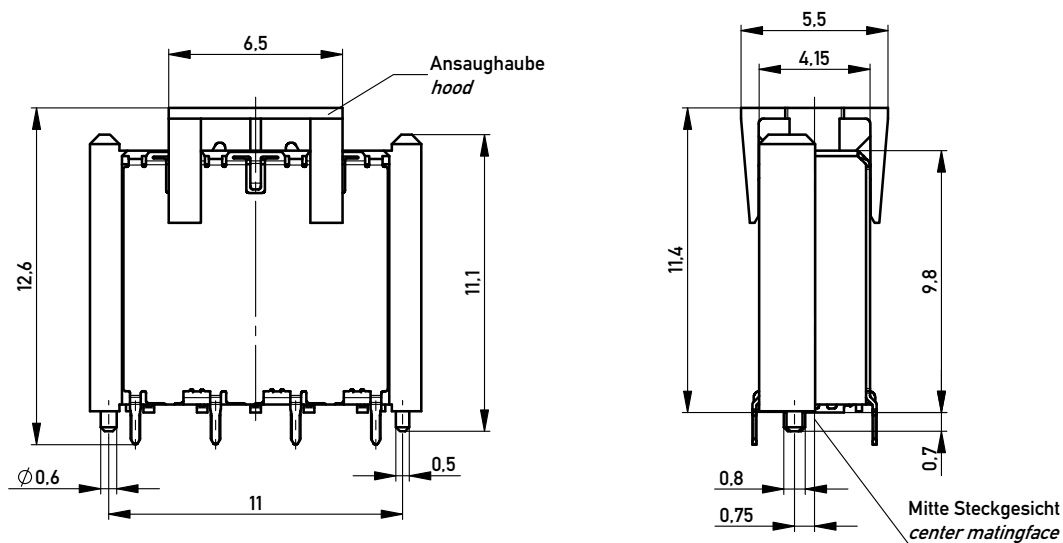
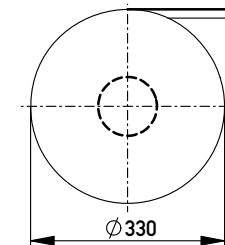
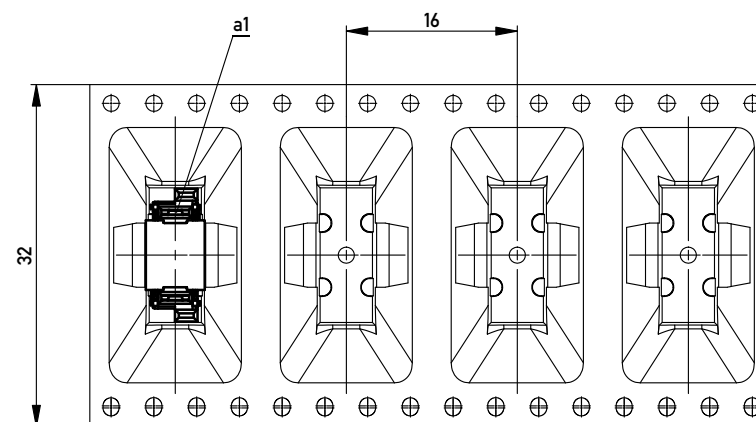

Leiterplatten-Layout Vorschlag / PCB-layout proposal

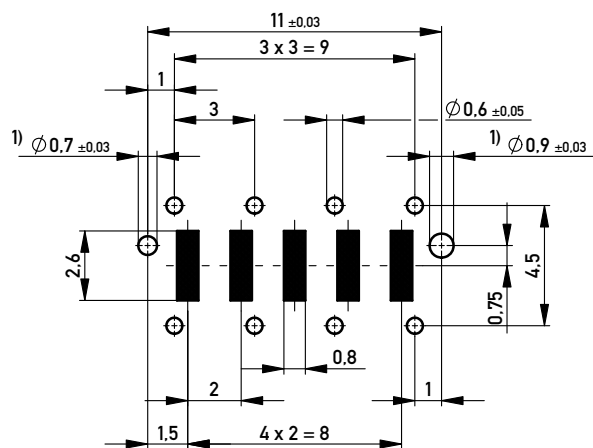

1) Durchmesser des Bohrers / Drill tool

Anforderungsstufe 1  
Performance Level 1

Kontaktbereich vergoldet  
Mating Area gold plating

Anschlussbereich verzinkt 4-6µm  
Terminal Area 4-6µm tin plating

Koplanarität der Anschlüsse ≤ 0,1mm  
Coplanarity Area of Termination ≤ 0,1mm

Information:	Tolerances	 All Dimensions in mm	Scale	5:1
	All rights reserved. Only for Information. To ensure that this is the latest version of this drawing, please contact one of the ERNI companies before using.			
Subject to modification without prior notice. Drawing will not be updated.	Designation		F10 MSPEED BlindMate PM THR	
	www.ERNI.com		354269	
b	19.09.2012	Class		MSPEED
Index	Date			I A3

Copyright by ERNI GmbH. Proprietary notice pursuant to ISO 9006 to be observed.